



Sri Sume Ship Ltd

Westend Center III



This is a 1,50,000 sq.ft. IT park that offers office premises ranging from 18,000 sq.ft. to 50,000 sq.ft. on lease on a bare shell or fully fitted basis.

Westend Center III

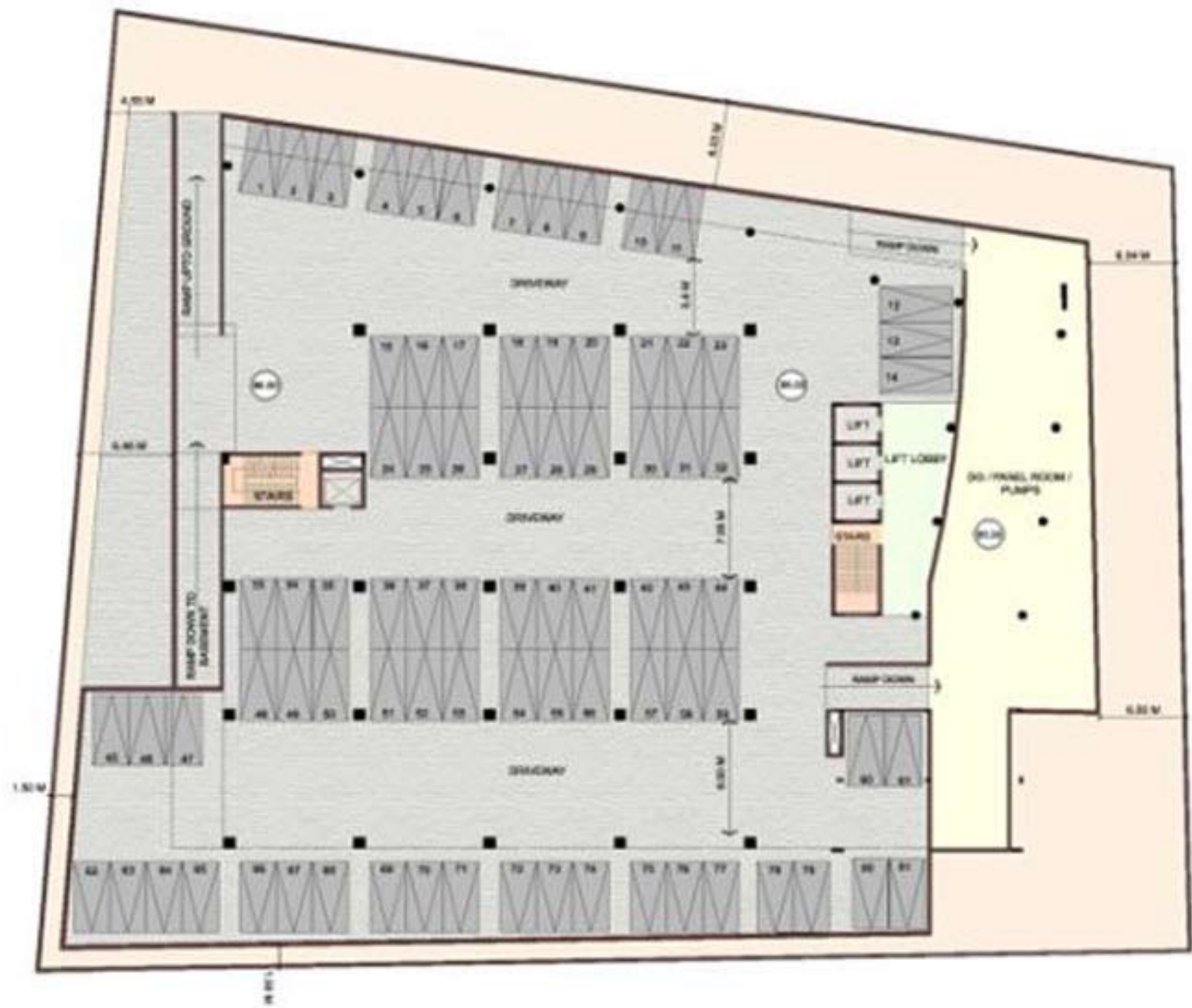

ASSIGNED ST. NO. LEVEL
TO BE CHANGED AT SITE

